

# Installation Instructions



LVLYXX  
120-277 or 347VAC Recessed Linear Light Fixture



**WARNING!** Luminaire must be installed by a qualified electrician. Refer to local codes for proper installation. To prevent shock disconnect power before installation on service.

**Y23**

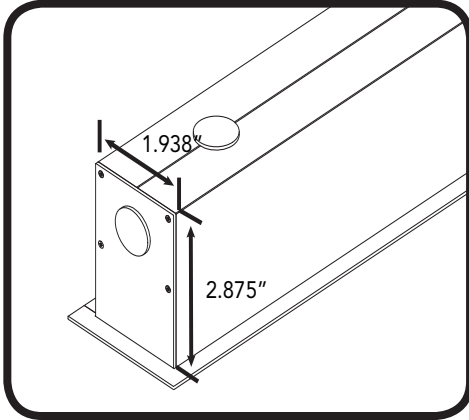

**Y33**

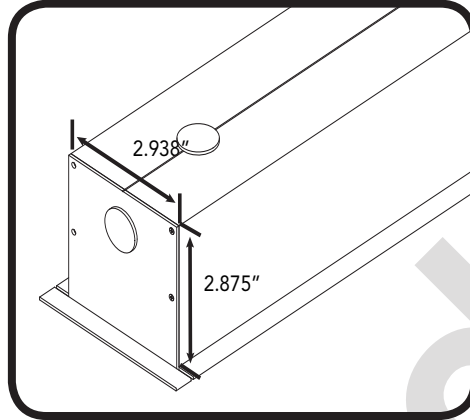

**Y43 & Y43C**

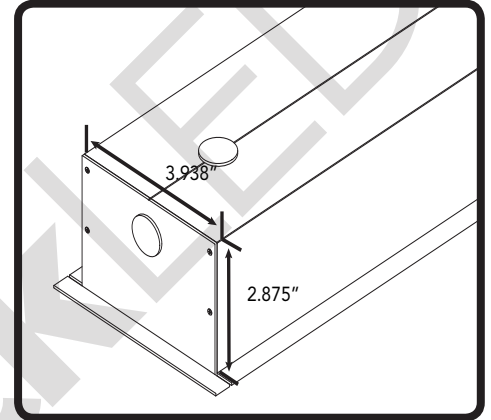

## Required Opening Size

Fixture	Dimension	Required Opening	Weight
<b>2ft Y23</b>	2" x 3" x 24"	2¼" x 3¼" x 24¼"	5 Lbs
<b>4ft Y23</b>	2" x 3" x 46"	2¼" x 3¼" x 46¼"	7 Lbs
<b>6ft Y23</b>	2" x 3" x 68"	2¼" x 3¼" x 68¼"	9 Lbs
<b>8ft Y23</b>	2" x 3" x 90"	2¼" x 3¼" x 90¼"	12 Lbs
<b>2ft Y33</b>	3" x 3" x 24"	3¼" x 3¼" x 24¼"	6 Lbs
<b>4ft Y33</b>	3" x 3" x 46"	3¼" x 3¼" x 46¼"	9 Lbs
<b>6ft Y33</b>	3" x 3" x 68"	3¼" x 3¼" x 68¼"	12 Lbs
<b>8ft Y33</b>	3" x 3" x 90"	3¼" x 3¼" x 90¼"	14 Lbs
<b>2ft Y43</b>	4" x 3" x 24"	4¼" x 3¼" x 24¼"	7 Lbs
<b>4ft Y43</b>	4" x 3" x 46"	4¼" x 3¼" x 46¼"	10 Lbs
<b>6ft Y43</b>	4" x 3" x 68"	4¼" x 3¼" x 68¼"	14 Lbs
<b>8ft Y43</b>	4" x 3" x 90"	4¼" x 3¼" x 90¼"	17 Lbs

## Direct Screw Installation

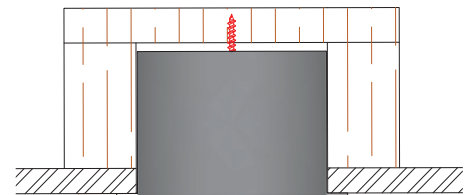

## Twist Clip Installation

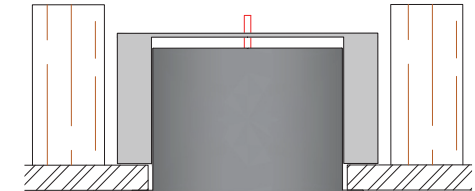

## Trimless Installation



## Drop-Ceiling Installation



# Installation Instructions



LVLYXX  
120-277 or 347VAC Recessed Linear Light Fixture

## Direct Screw Installation

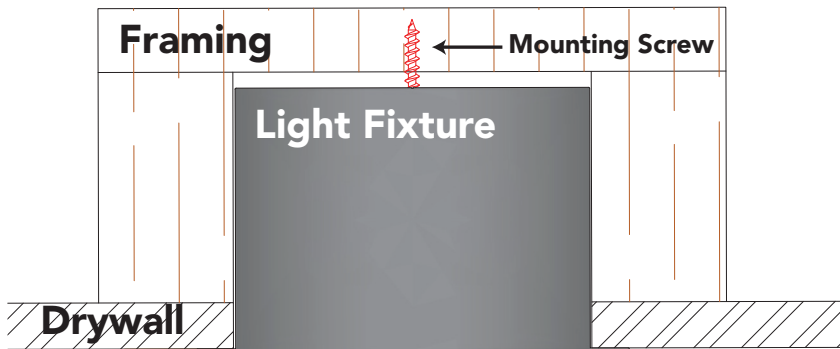

## Recommended Installation Method!

**Framing Required!** Build framing on sides and top of light fixture for support.

**Create Opening:** Refer to chart on **Page 1** for required opening size.

**Type IC:** Suitable for IC contact.

**Inherently Protected**

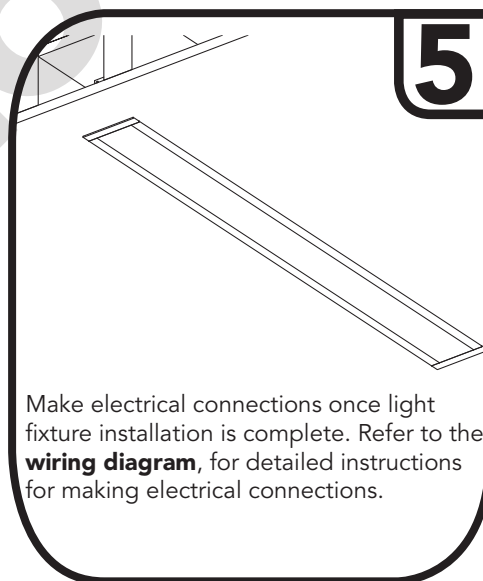
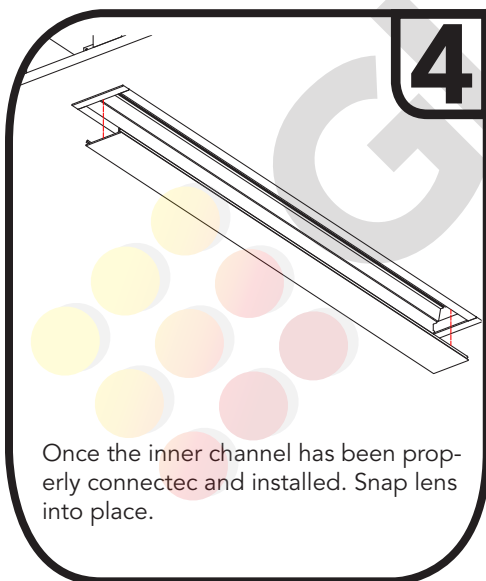
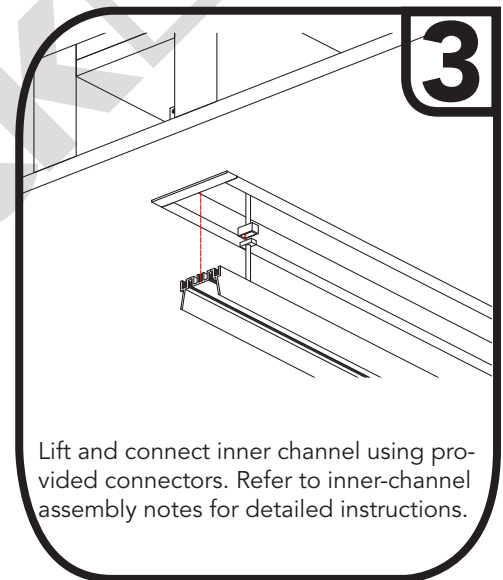
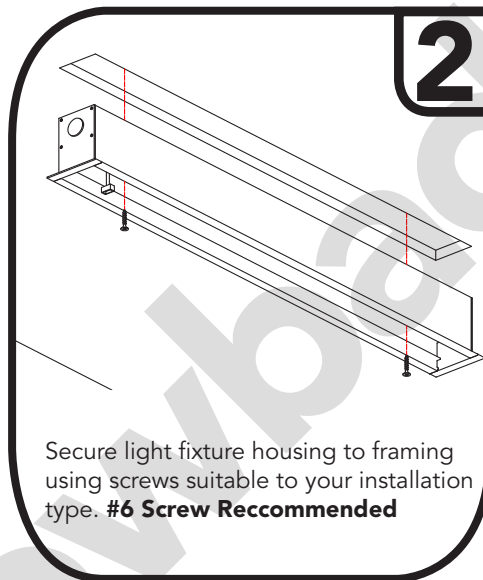
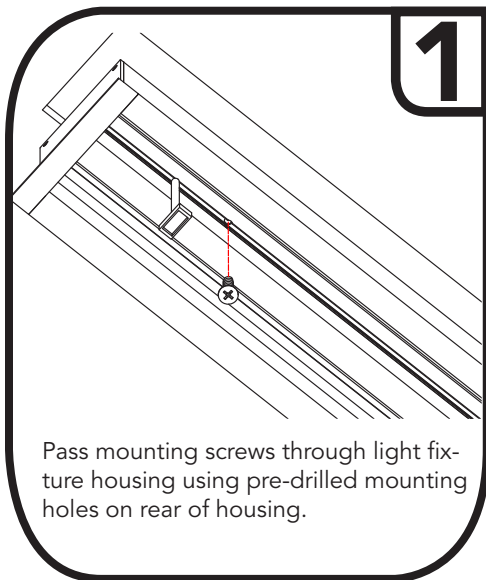

**GlowbackLED®**

16409 NW 8<sup>th</sup> Ave

Miami Gardens, FL 33169

1-800-679-4902 • info@bluegateinc.com

GlowbackLED® is a registered trademark of Bluegate Inc  
©2018 Bluegate Inc. All Rights Reserved

Specifications subject to change without notice



# Installation Instructions



LVLYXX  
120-277 or 347VAC Recessed Linear Light Fixture

## Twist-Clip Installation

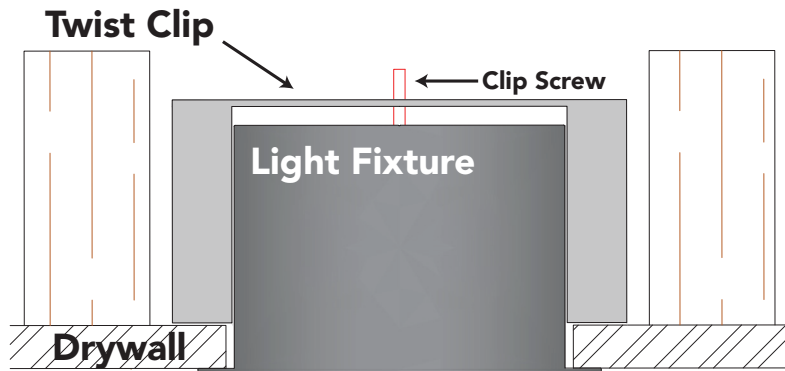

**Twist Clip Mounting:** Specialized clip secures light fixture to drywall.

**Create Opening:** Refer to chart on **Page 1** for required opening size.

**Type IC:** Suitable for IC contact.

**Inherently Protected**

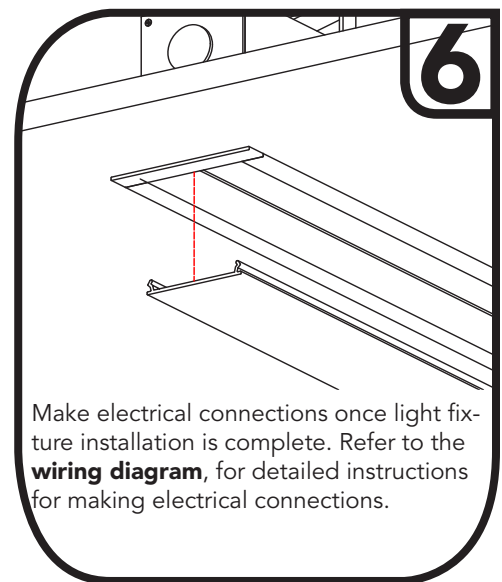
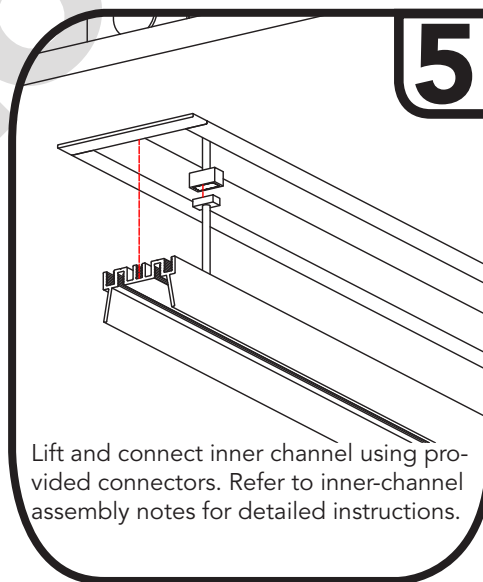
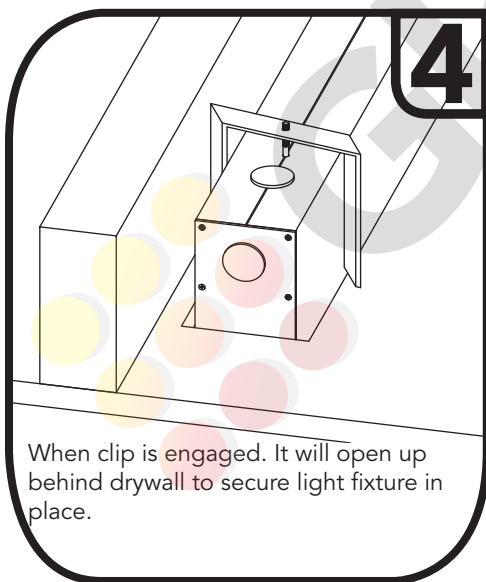
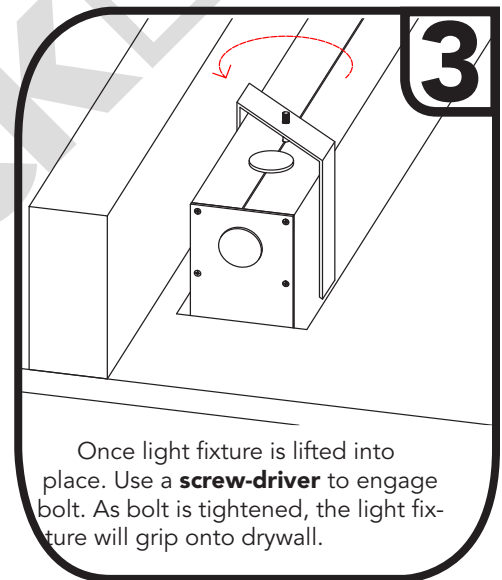
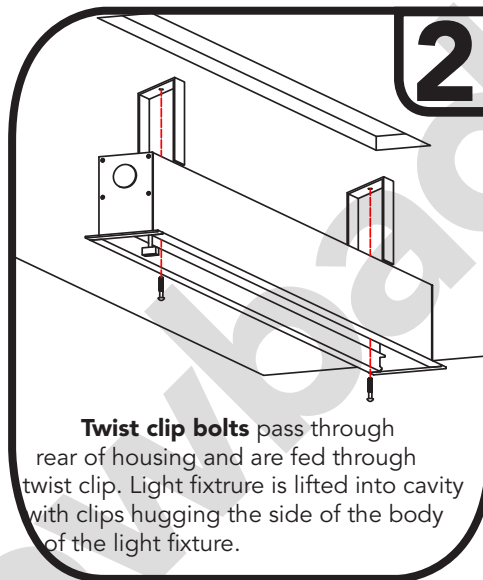
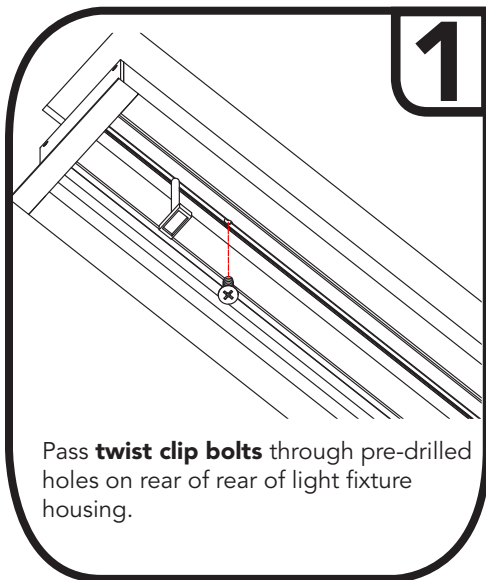

**GlowbackLED®**  
16409 NW 8<sup>th</sup> Ave  
Miami Gardens, FL 33169  
1-800-679-4902 • info@bluegateinc.com

GlowbackLED® is a registered trademark of Bluegate Inc  
©2018 Bluegate Inc. All Rights Reserved  
Specifications subject to change without notice



# Installation Instructions



LVLYXX  
120-277 or 347VAC Recessed Linear Light Fixture

## Drop Ceiling Installation



**Adjustable Grid-Bracket:** Adaptable to any grid structure and configuration.

**Opening:** Refer to chart on **Page 1** for required opening size. Opening created using grid-structure.

**Suspension:** Grid system must be suspended from ceiling and able to support weights listed on **Page 1**.

**Type IC:** Suitable for IC contact.

**Inherently Protected**

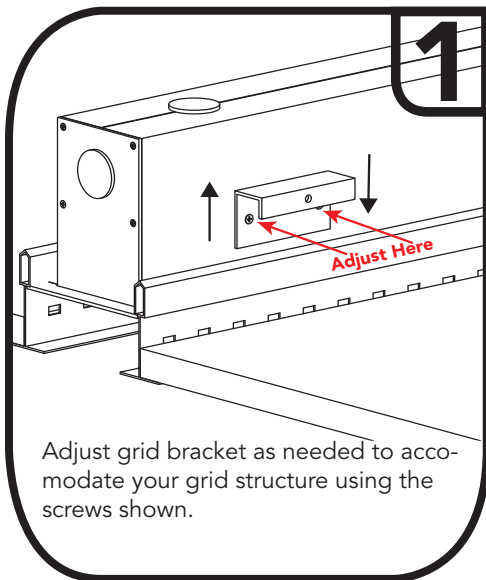

Adjust grid bracket as needed to accommodate your grid structure using the screws shown.

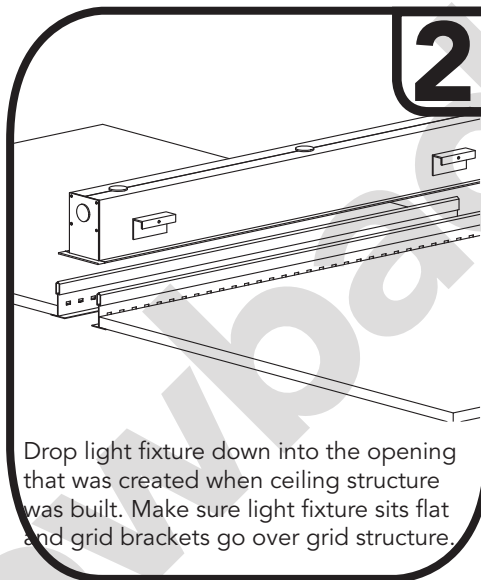

Drop light fixture down into the opening that was created when ceiling structure was built. Make sure light fixture sits flat and grid brackets go over grid structure.

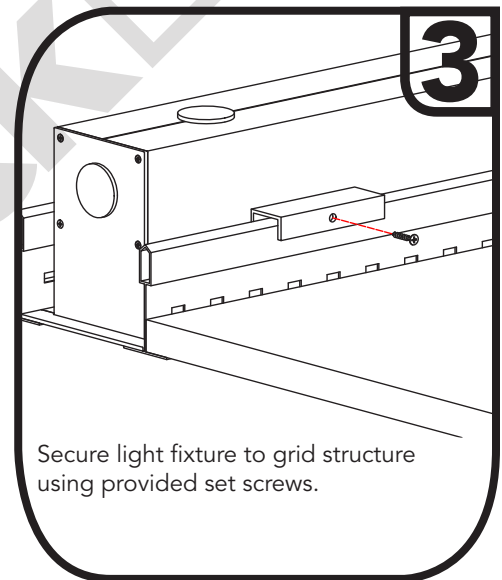

Secure light fixture to grid structure using provided set screws.

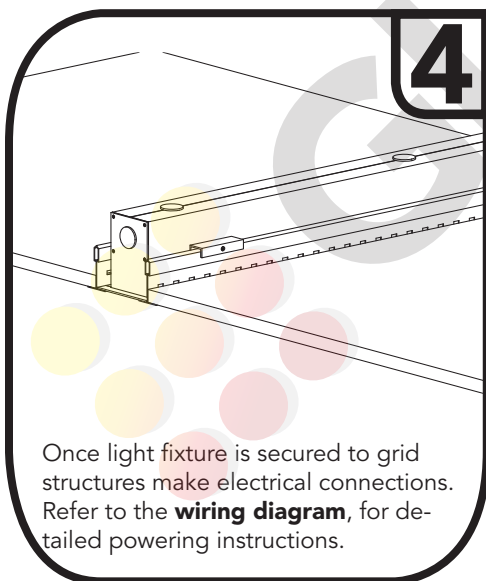

Once light fixture is secured to grid structures make electrical connections. Refer to the **wiring diagram**, for detailed powering instructions.

**GlowbackLED®**  
16409 NW 8<sup>th</sup> Ave  
Miami Gardens, FL 33169  
1-800-679-4902 • info@bluegateinc.com

GlowbackLED® is a registered trademark of Bluegate Inc  
©2018 Bluegate Inc. All Rights Reserved  
Specifications subject to change without notice



# Installation Instructions



LVLYXX  
120-277 or 347VAC Recessed Linear Light Fixture

## Twist-Clip Installation

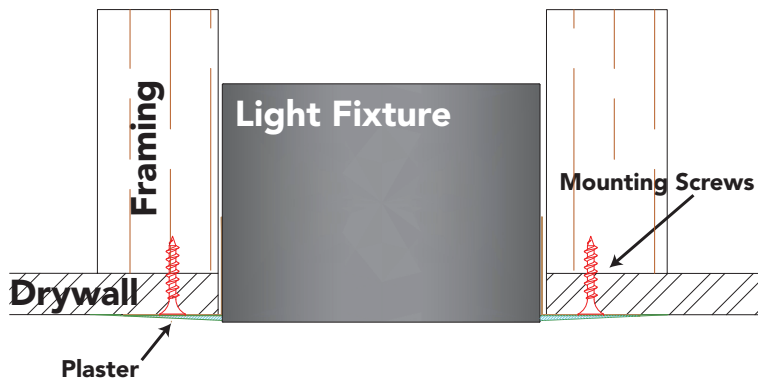

**Framing Required!** Build framing on either side of light fixture.

**Create Opening:** Refer to chart on **Page 1** for required opening size.

**Screw Spacing:** Mounting screws are required every 16" on center. **#6 Screw Recommended**

**Type IC:** Suitable for IC contact.

**Inherently Protected**

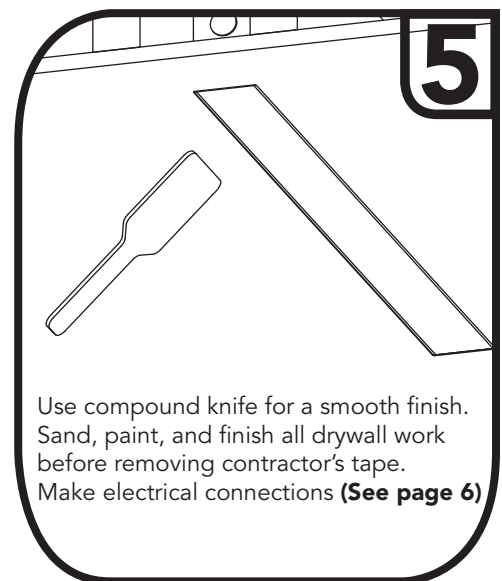
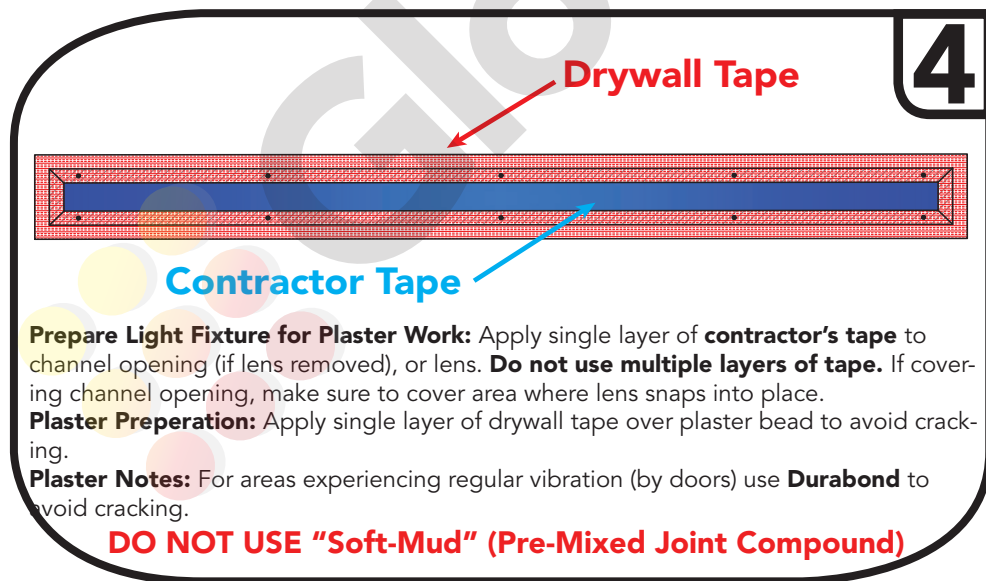
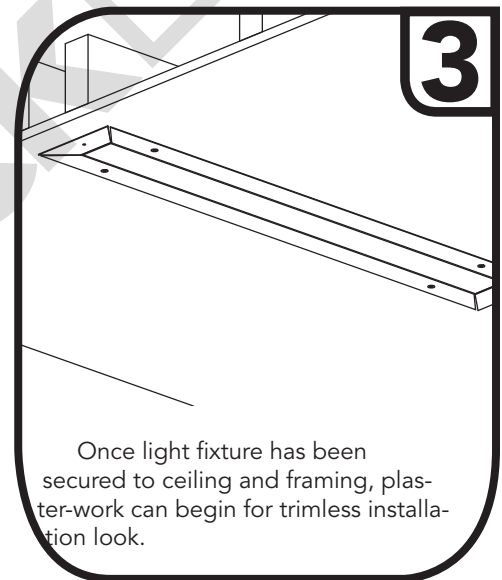
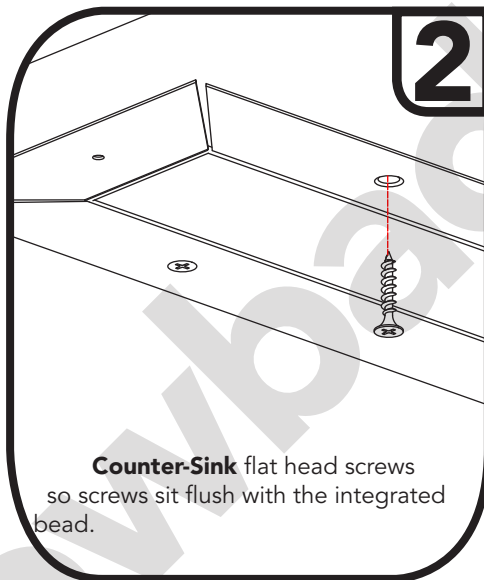
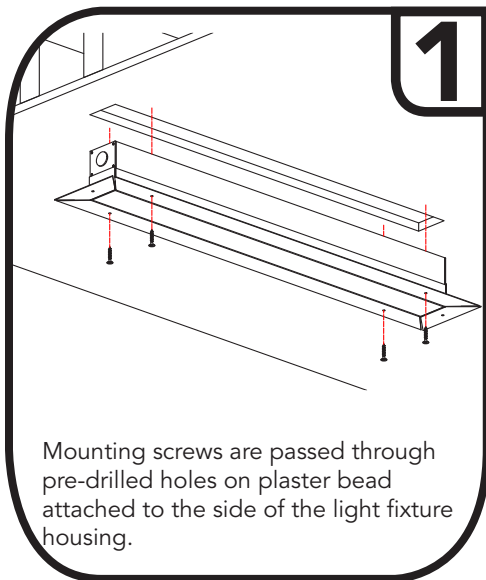

**GlowbackLED®**  
16409 NW 8<sup>th</sup> Ave  
Miami Gardens, FL 33169  
1-800-679-4902 • info@bluegateinc.com

GlowbackLED® is a registered trademark of Bluegate Inc  
©2018 Bluegate Inc. All Rights Reserved  
Specifications subject to change without notice





# Installation Instructions



LVLYXXX  
120-277 or 347VAC Recessed Linear Light Fixture

## Linkable/Continuous Run Connections

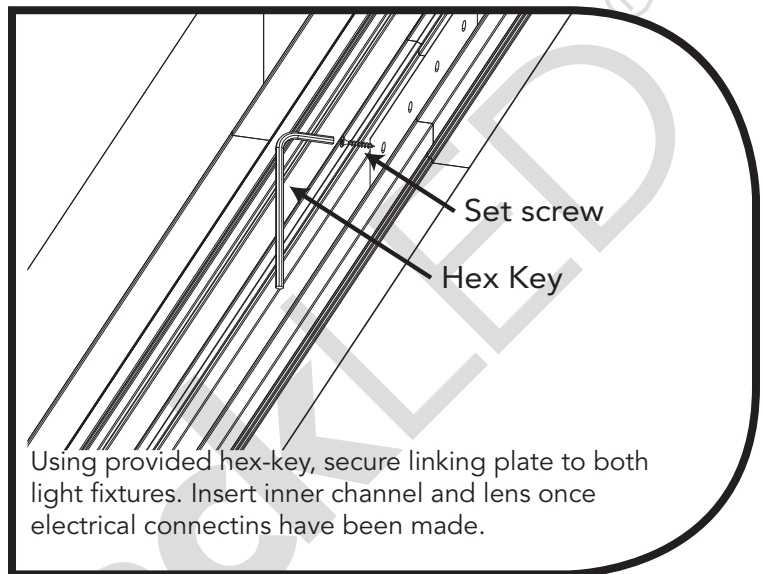
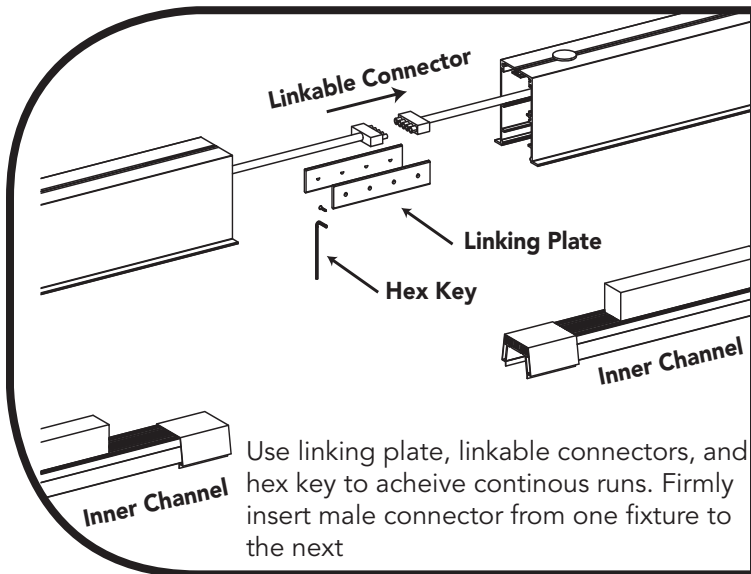

## Inner Clip Connection

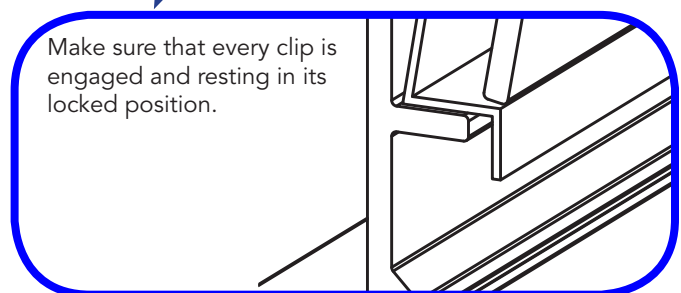
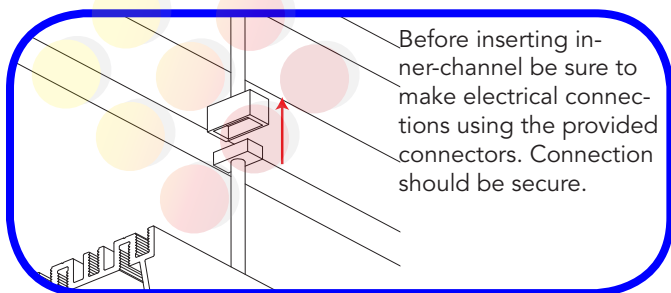
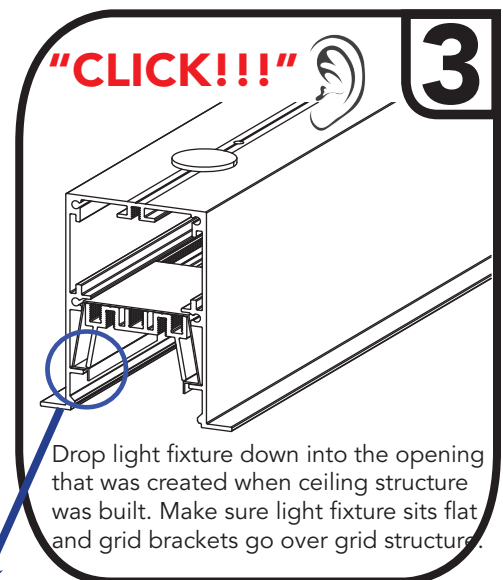
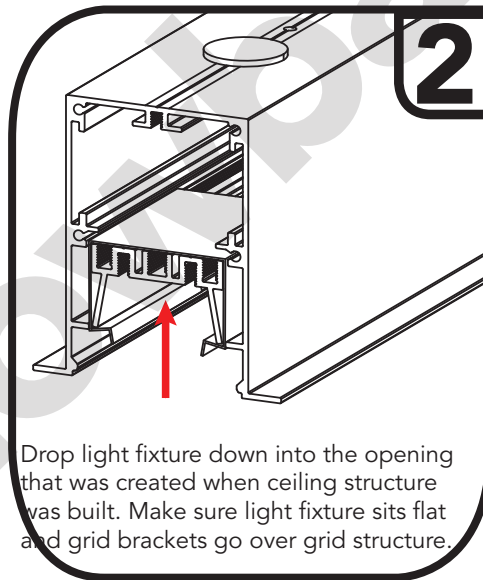
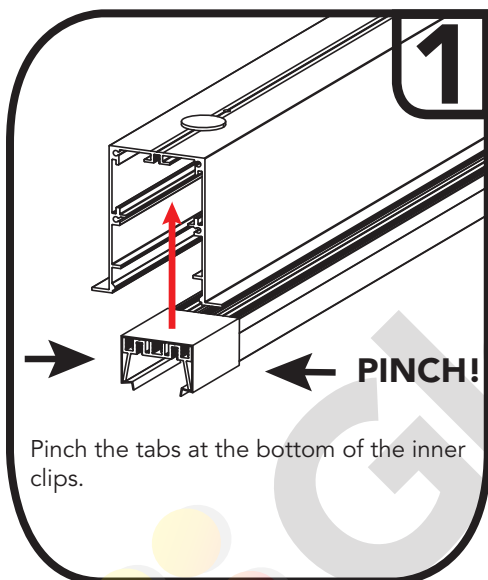

**GlowbackLED®**  
16409 NW 8<sup>th</sup> Ave  
Miami Gardens, FL 33169  
1-800-679-4902 • info@bluegateinc.com

GlowbackLED® is a registered trademark of Bluegate Inc  
©2018 Bluegate Inc. All Rights Reserved  
Specifications subject to change without notice



# Installation Instructions



LVLYXXX  
120-277 or 347VAC Recessed Linear Light Fixture

## Power-Feed Entry and Electrical Connections

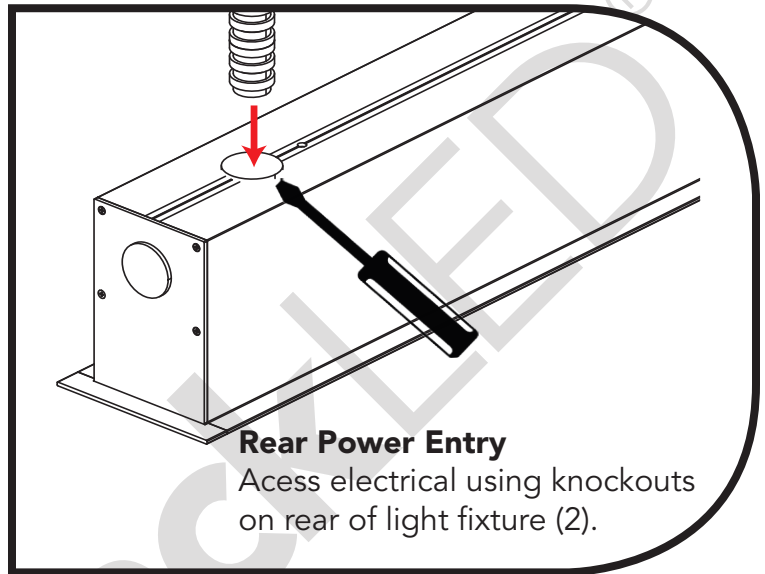
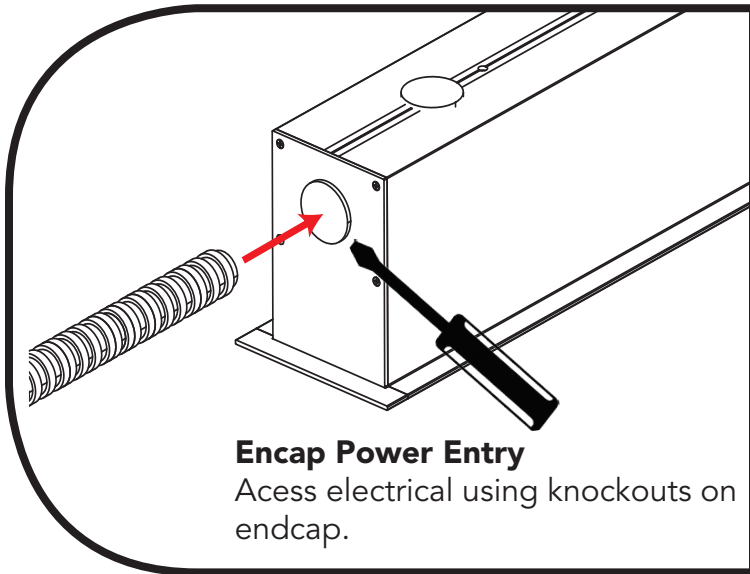

## Non-Dimmable Configuration

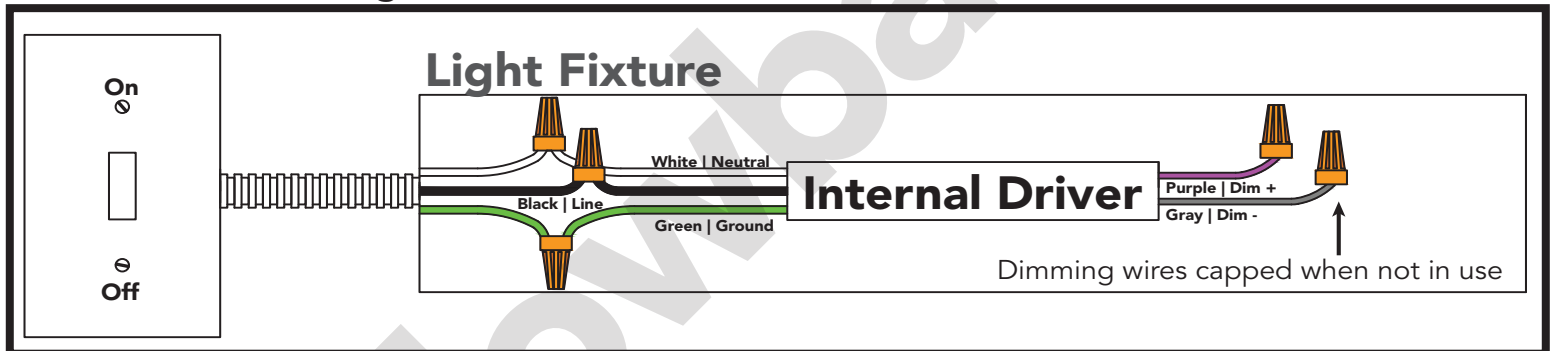

## Dimmable Configuration

