

Installation Instructions



LED BAR III & IV Y
Low-Voltage 12-24VDC Recessed Light Fixture



WARNING! Luminaire must be installed by a qualified electrician. Refer to local codes for proper installation. To prevent shock disconnect power before installation on service.

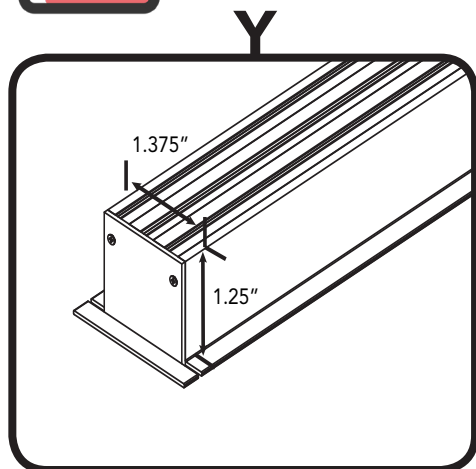

Direct Screw Installation

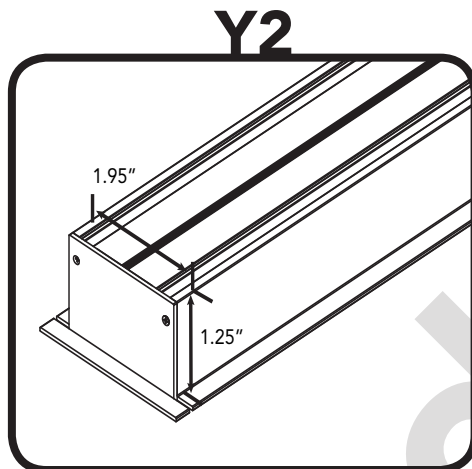

Twist Clip Installation

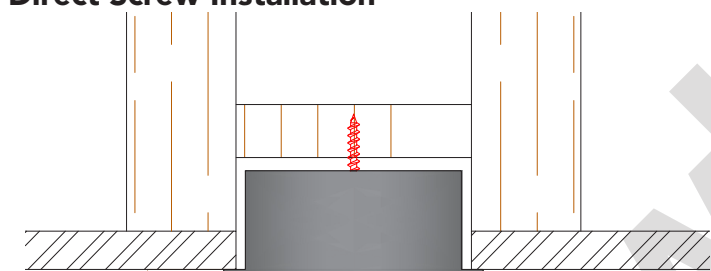
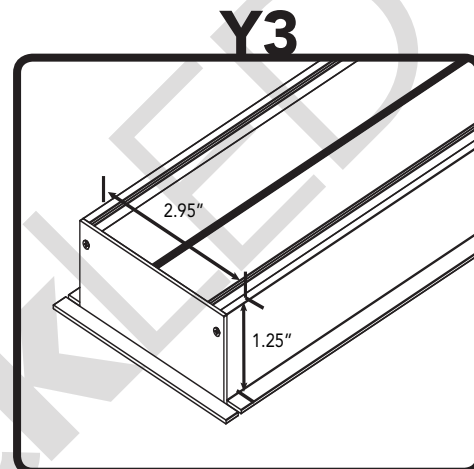

Drop Ceiling Installation

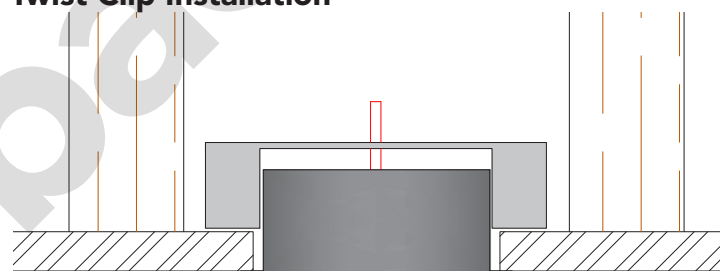

Trimless Installation

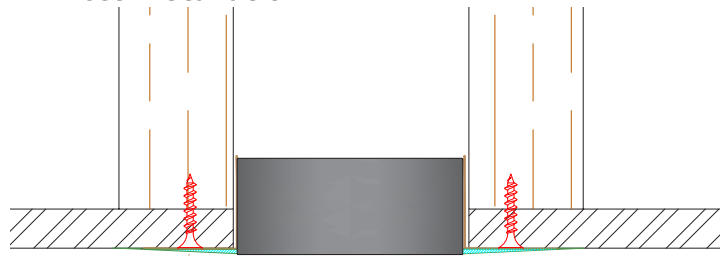
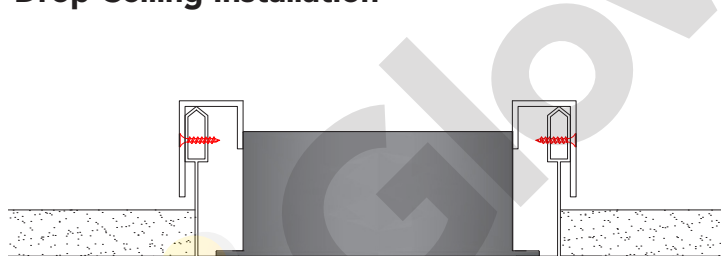

Required Opening Size

Fixture	Dimension	Required Opening	Weight
Y	1.375" W x 1 1/4" H x up to 96"	1 1/4" W x 1 1/4" H x Length	1/2 Lb/ft
Y2	2" W x 1 1/4" H x up to 96"	2 1/4" W x 1 1/4" H x Length	3/4 Lb/ft
Y3	3" W x 1 1/4" H x up to 96"	3 1/4" W x 1 1/4" H x Length	1 Lb/ft

Installation Instructions



LEDBARIII&IVY
Low-Voltage 12-24VDC Recessed Light Fixture

Direct Screw Installation

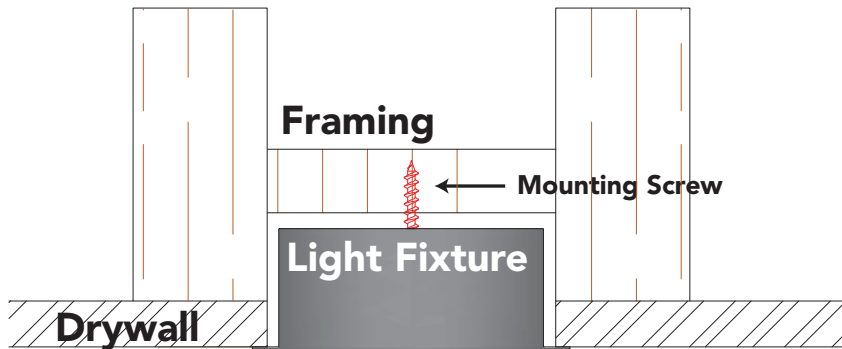

Reccomended Installation Method!

Framing Required! Build framing on sides and top of light fixture for support.

Create Opening: Refer to chart on **Page 1** for required opening size.

Framing NOT required for solid/concrete ceilings!

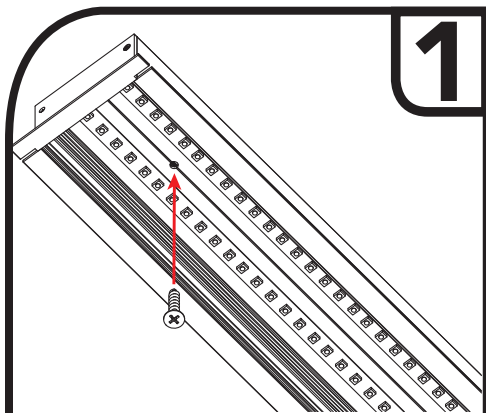

Pass mounting screws through light fixture housing using pre-drilled mounting holes on rear of housing.

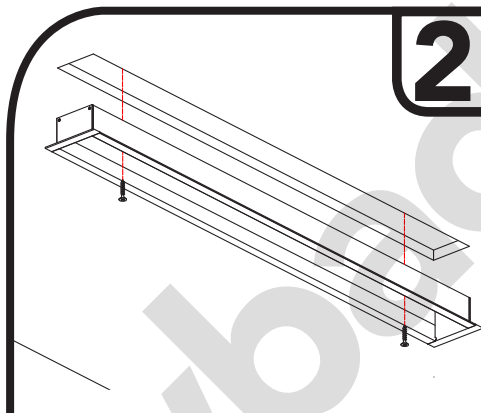

Secure light fixture housing to framing using screws suitable to your installation type. **#6 Screw Recommended**

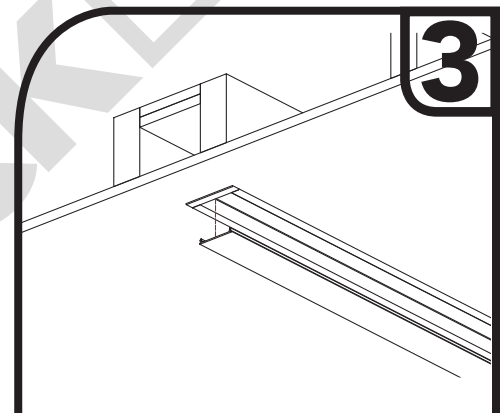

Once light fixture housing has been secured to framing, install lens by snapping into place.

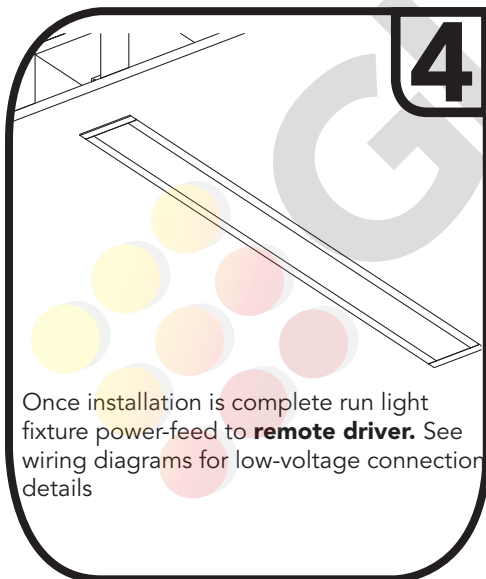

Once installation is complete run light fixture power-feed to **remote driver**. See wiring diagrams for low-voltage connection details

GlowbackLED®

16409 NW 8th Ave

Miami Gardens, FL 33169

1-800-679-4902 • info@bluegateinc.com

GlowbackLED® is a registered trademark of Bluegate Inc
©2018 Bluegate Inc. All Rights Reserved

Specifications subject to change without notice



Installation Instructions



LEDBARIII&IVY
Low-Voltage 12-24VDC Recessed Light Fixture

Twist-Clip Installation

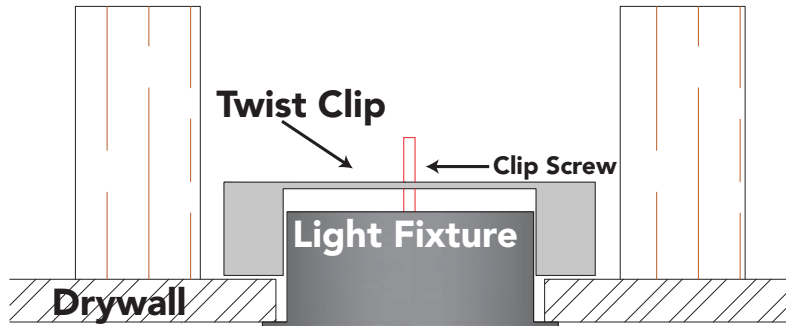

Twist Clip Mounting: Specialized clip secures light fixture to drywall.

Create Opening: Refer to chart on **Page 1** for required opening size.

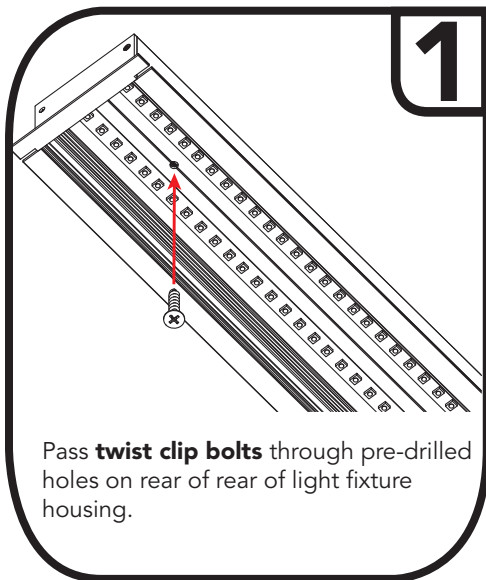

Pass **twist clip bolts** through pre-drilled holes on rear of rear of light fixture housing.

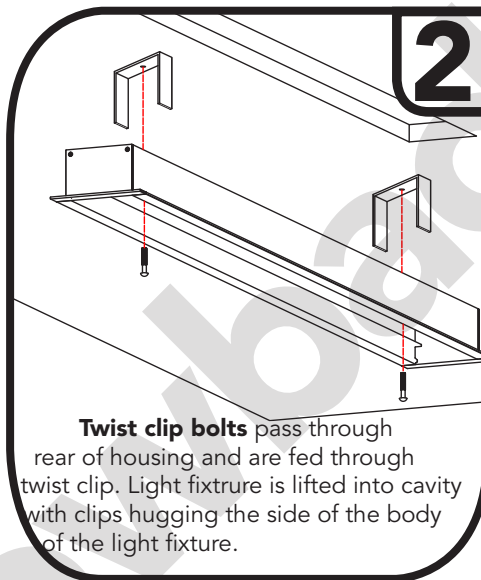

Twist clip bolts pass through rear of housing and are fed through twist clip. Light fixture is lifted into cavity with clips hugging the side of the body of the light fixture.

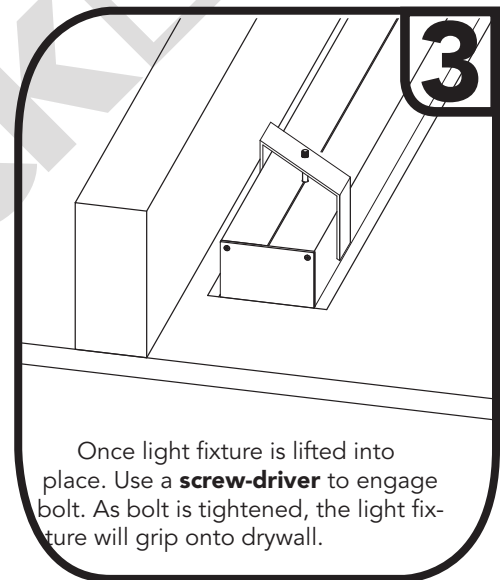

Once light fixture is lifted into place. Use a **screw-driver** to engage bolt. As bolt is tightened, the light fixture will grip onto drywall.

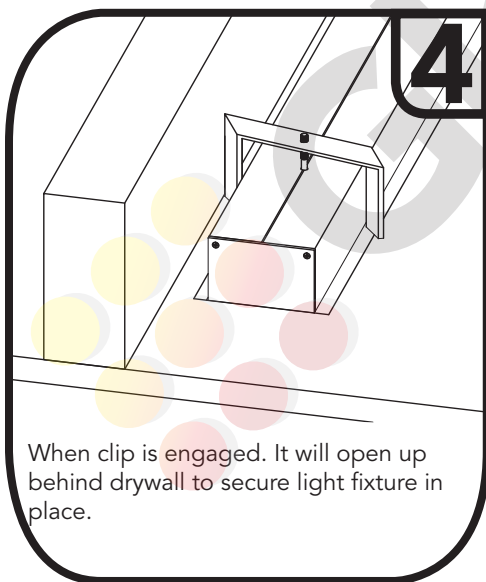

When clip is engaged. It will open up behind drywall to secure light fixture in place.

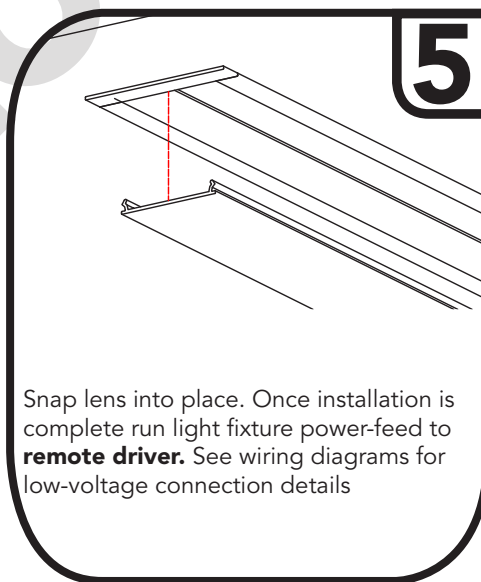

Snap lens into place. Once installation is complete run light fixture power-feed to **remote driver**. See wiring diagrams for low-voltage connection details

GlowbackLED®

16409 NW 8th Ave

Miami Gardens, FL 33169

1-800-679-4902 • info@bluegateinc.com

GlowbackLED® is a registered trademark of Bluegate Inc
©2018 Bluegate Inc. All Rights Reserved

Specifications subject to change without notice



Installation Instructions



LEDBARIII&IVY
Low-Voltage 12-24VDC Recessed Light Fixture

Drop Ceiling Installation

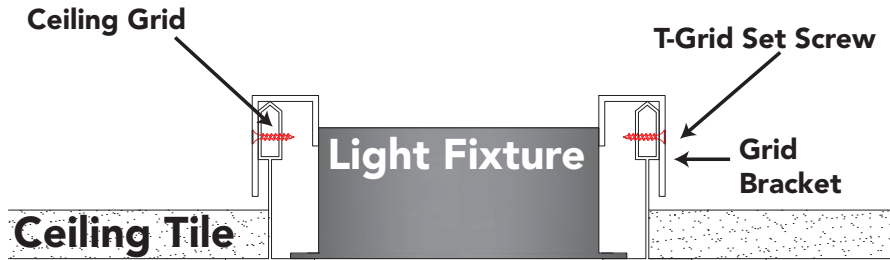

Adjustable Grid-Bracket: Adaptable to any grid structure and configuration.

Opening: Refer to chart on **Page 1** for required opening size. Opening created using grid-structure.

Suspension: Grid system must be suspended from ceiling and able to support weights listed on **Page 1**.

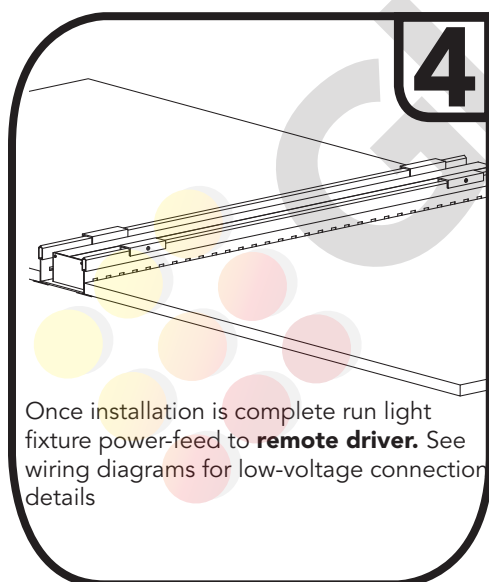
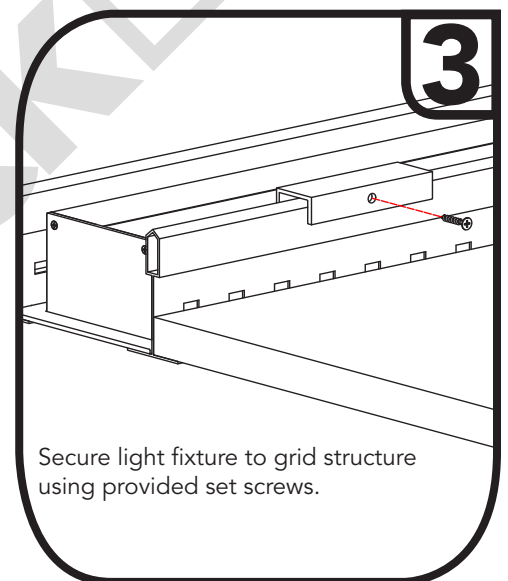
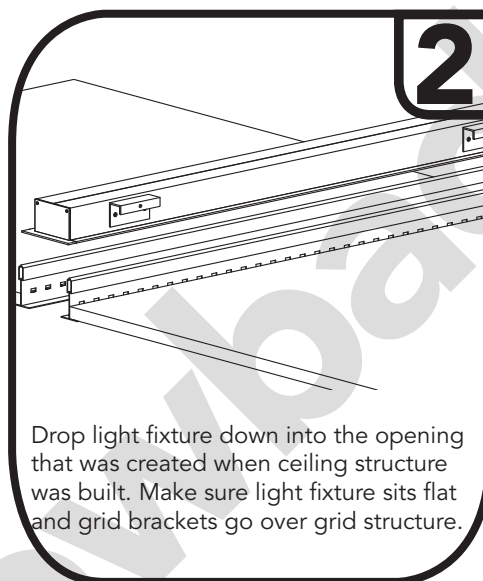
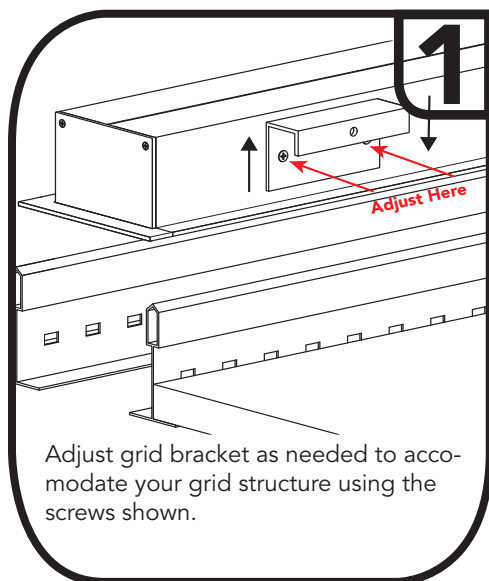

GlowbackLED®
16409 NW 8th Ave
Miami Gardens, FL 33169
1-800-679-4902 • info@bluegateinc.com

GlowbackLED® is a registered trademark of Bluegate Inc
©2018 Bluegate Inc. All Rights Reserved
Specifications subject to change without notice



Installation Instructions



LEDBARIII&IVY
Low-Voltage 12-24VDC Recessed Light Fixture

Trimless Installation

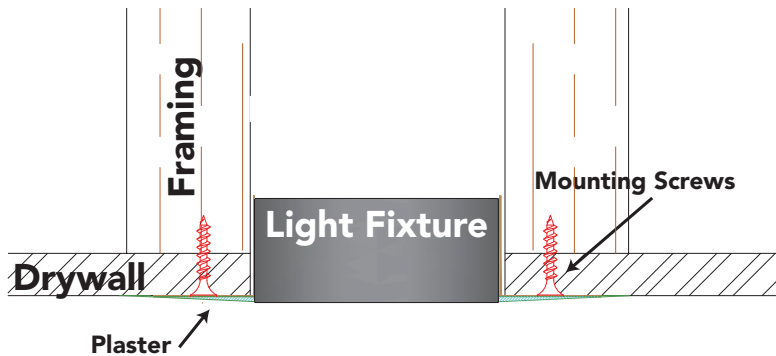

Framing Required! Build framing on either side of light fixture.

Create Opening: Refer to chart on **Page 1** for required opening size.

Screw Spacing: Mounting screws are required every 16" on center. **#6 Screw Recommended**

Framing NOT required for solid/concrete ceilings!

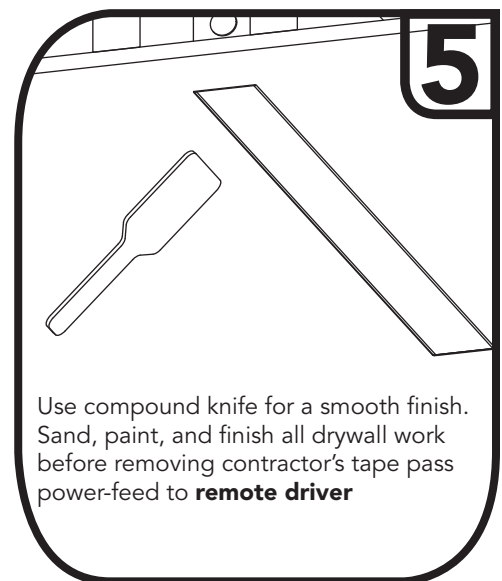
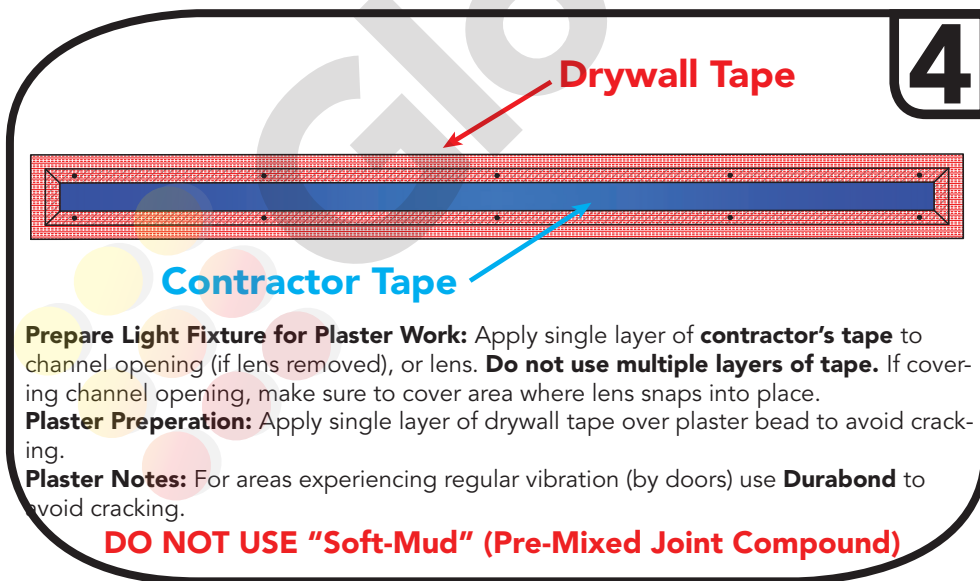
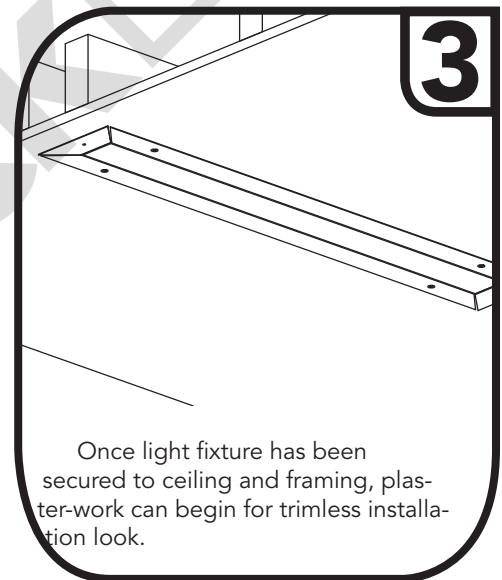
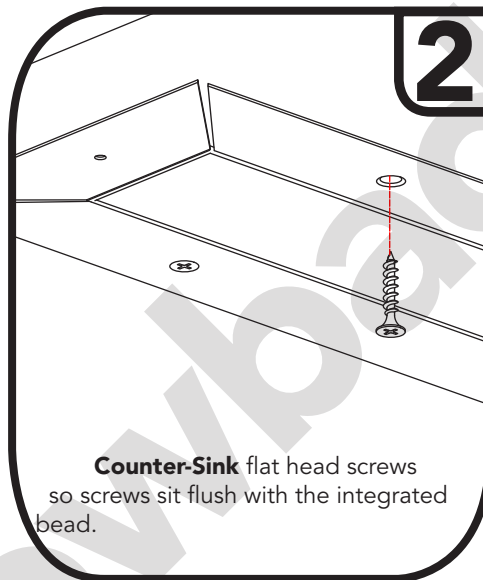
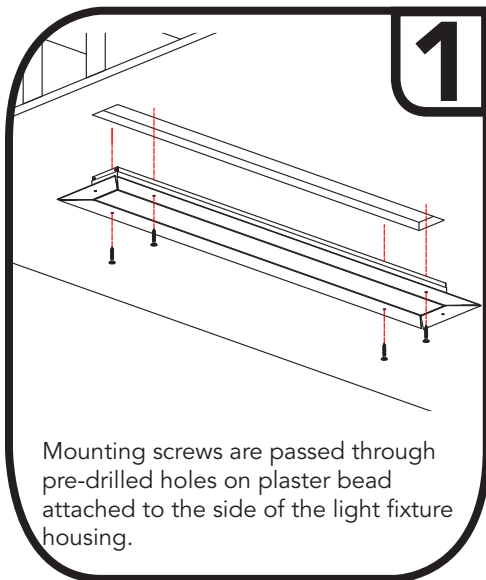

GlowbackLED®
16409 NW 8th Ave
Miami Gardens, FL 33169
1-800-679-4902 • info@bluegateinc.com

GlowbackLED® is a registered trademark of Bluegate Inc
©2018 Bluegate Inc. All Rights Reserved
Specifications subject to change without notice



Installation Instructions



LEDBARIII&IVY
Low-Voltage 12-24VDC Recessed Light Fixture

Linkable/Continuous Run Connections

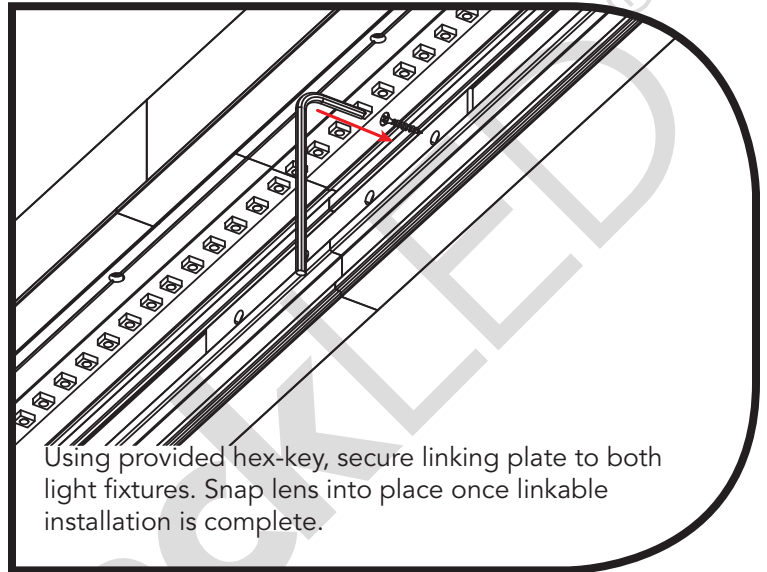
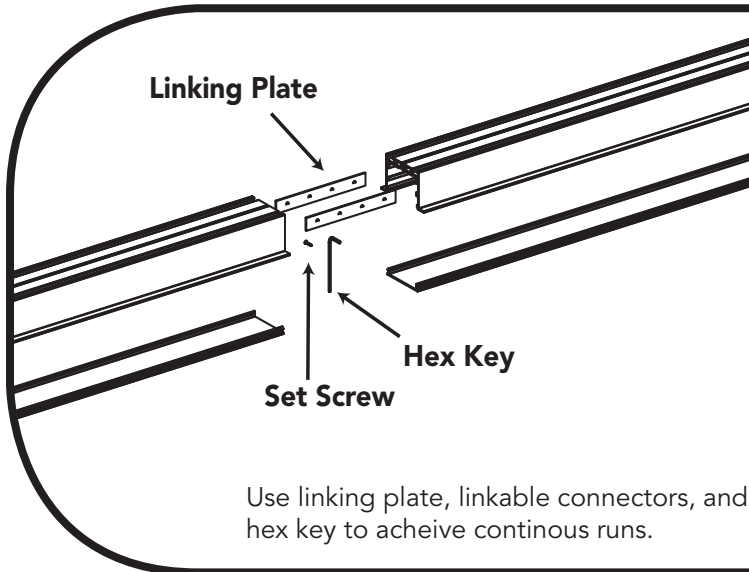

Powerfeed Options

Endcap Power-Feed

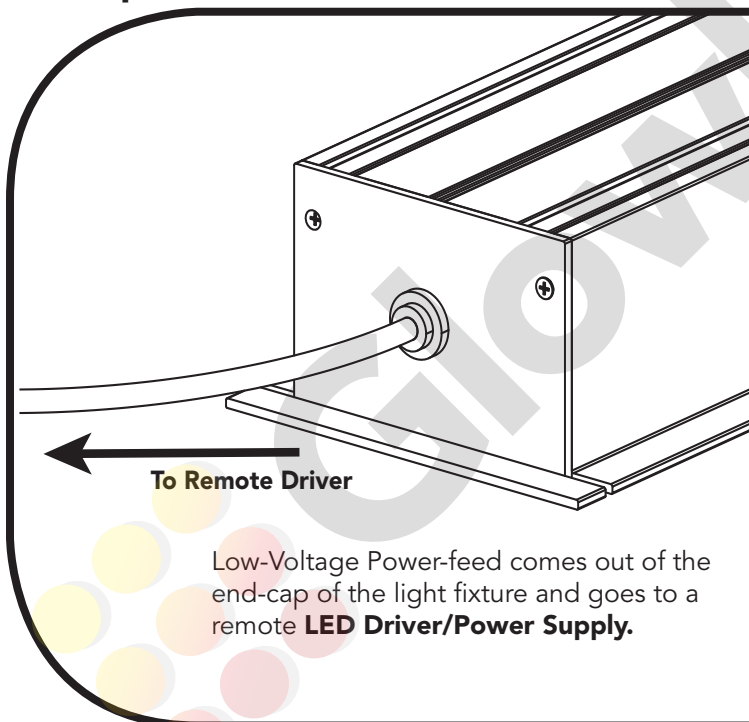

Rear Power-Feed

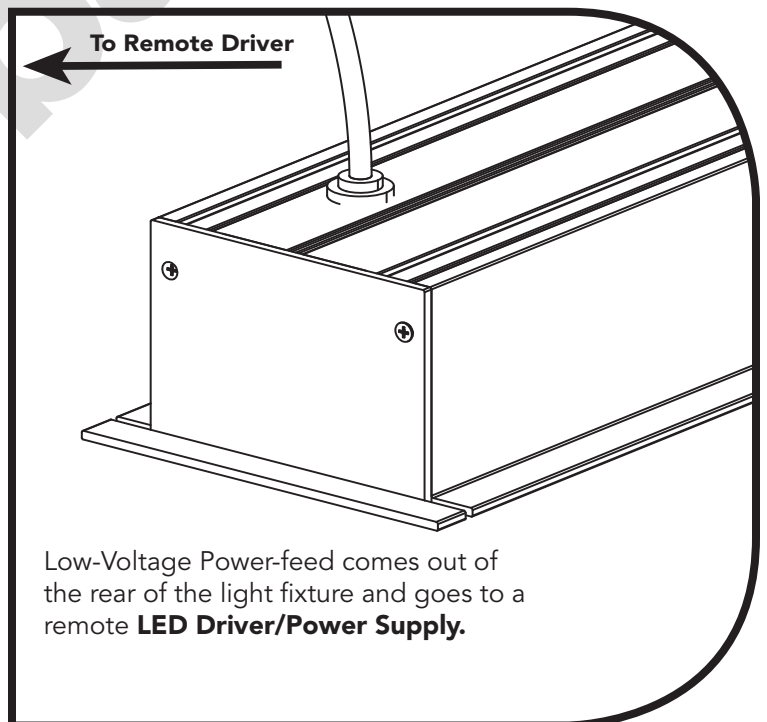

Installation Instructions



LED BAR III & IV
Low-Voltage 12-24VDC Recessed Light Fixture

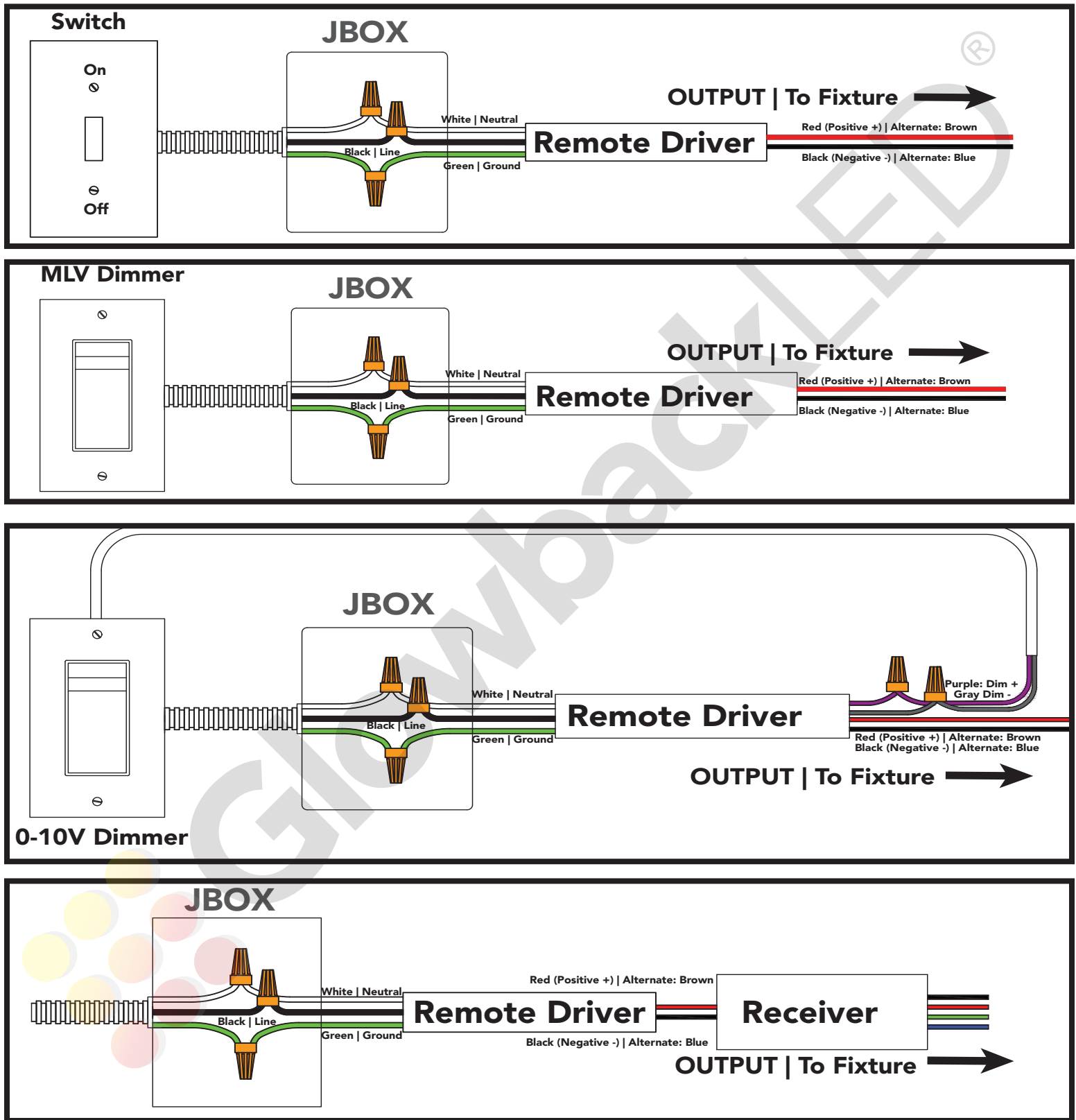

GlowbackLED®
16409 NW 8th Ave
Miami Gardens, FL 33169
1-800-679-4902 • info@bluegateinc.com

GlowbackLED® is a registered trademark of Bluegate Inc
©2018 Bluegate Inc. All Rights Reserved
Specifications subject to change without notice

